

Unit : mm (± 0.5)

Feature ■

- TV out : live & playback
- RTC(real-time clock)
- Normal REC
- Loop overwrite REC
- Motion detect REC
- capture picture
- Micro SDHC card slot (support up to 32GB)

Specification

Model	MP-550
AV recorder resolution	640x480(VGA) / max 30 fps.
External Memory	SD Card memory slot (support up to 32 GB)
Compression	MPEG 4 ASF file
Video	Synchronized audio & video recording/ playback
Video Output	TV out /AV in (NTSC/PAL)
Function	AV In Mode , Rec Mode , SD card Update , Snapshot , motion detect , loop overwrite , RTC date and time stamping
Power charge	DC 5V(450mA)
Battery	Li-ion battery ,NP-60 (1030mAh)
PC Interface	USB1.1
Dimension	40 x 90 mm



▲ MP-550

Format SDHC

Improve the SD SDHC Card 4GB ~32GB compatibility MP-550 support for SDHC, SDHC card(OVER 4GB~32GB) must be special format processing ! through the pc to format SDHC Card Fat32 block size 16k
WINDOWS SYSTEM
1.Click [Start],
process:
2.then click the [running] 'button',
3. [Open] box, type: "diskmgmt.msc", and then click [OK],
then Right-click on SDHC CARD DISK and format block size 16 or 32K

MP-550 MAIN DEVICE

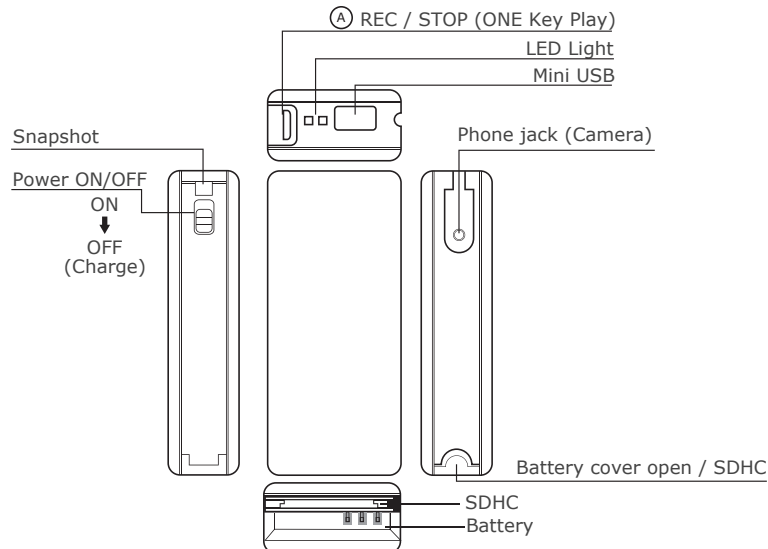

By connecting with an external video sensor, it can record the video (MPEG 4 ASF file, 640x480(VGA) / max 30 fps. & Snapshot JPG image)

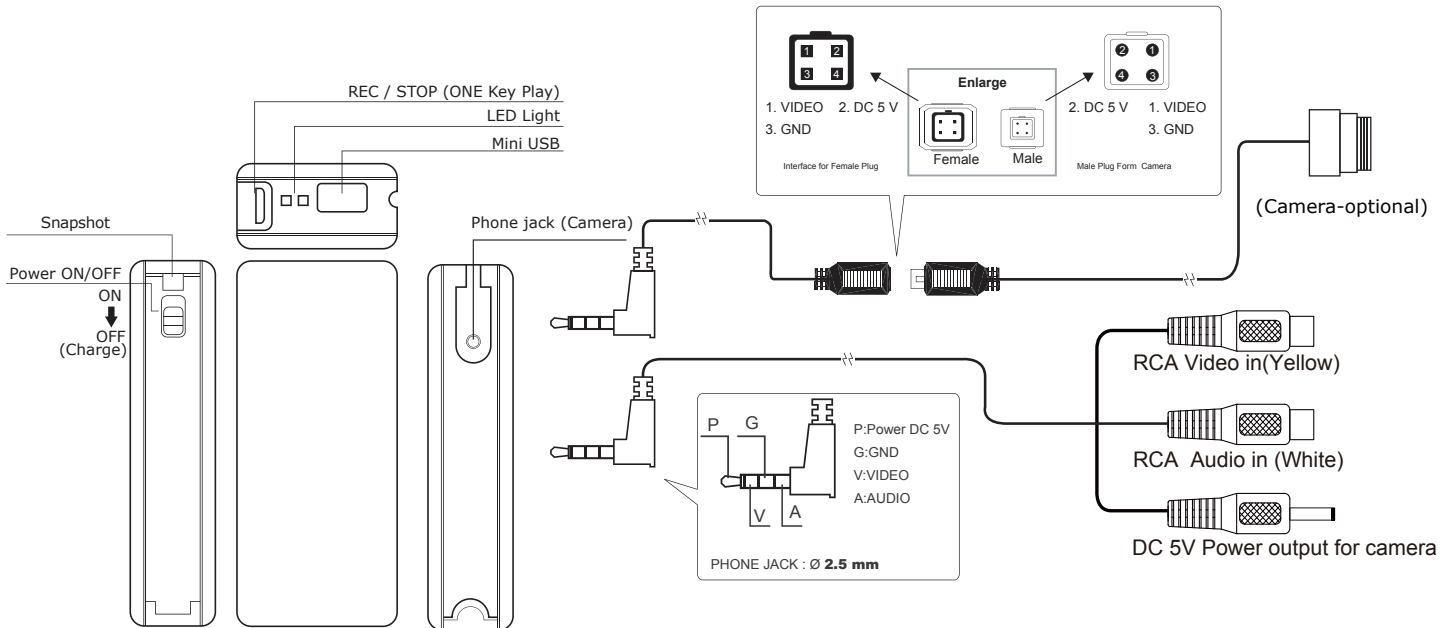

Setting

- You can set any function what you want by this way
- SD connected computer and add folder "MISC"
- After open "MISC" folder and then add TXT file "SYSCFG.TXT" and type:
(Changing the TXT file to start what you need system)

[COMMON]

DATE=2010-04-26 Date=year-month-date

TIME=09:25 time=Minutes:seconds

// **NTSC/60, PAL/50**

SENSORTYPE=NTSC NTSC or PAL

TVTYPE=NTSC NTSC or PAL

TVFREQHz=60 NTSC=60 or PAL=50

RESET=0

[DVINFO]/60, 50

SENSORFREQHz=60 NTSC=60 or PAL=50

// **NORMAL, CYCLE, MOTION, MOTION_CYCLE**

DVRECTYPE=NORMAL NORMAL, CYCLE, MOTION, MOTION_CYCLE

DVRECTIMEBAR=YES YES or NO

[DSCINFO]

#END

- **NORMAL MODE:** Recording, the SHDC card will save video file in every **30 minutes** until card memory full
- **CYCLE MODE:** Recording, the SHDC card will save video file in every **30 minutes**. If the memory card full, the video file will be overwritten automatically
- **MOTION MODE:** When motion trigger started the SHDC card will save video file in every **30 sec.** until card memory full
- **MOTION_CYCLE MODE:** When motion trigger started the SHDC card will save video file in every **30 sec.** If the memory card full, the video file will be overwritten automatically

Boot after waiting for about 10 ~ 15 sec and off power, The system will read and delete the configuration file

(do not perform other operations, will lead to a configuration parameter can not be saved)

Motion Detect Area

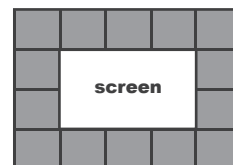

Motion Detect Area must be detected by around of screen

Motion detect and have to 4 GB SD card or more than 4GB SD card.

Link With Other Equipments**1. Output to TV screen**

a. AV cable connect MP-550 that will preview mode.

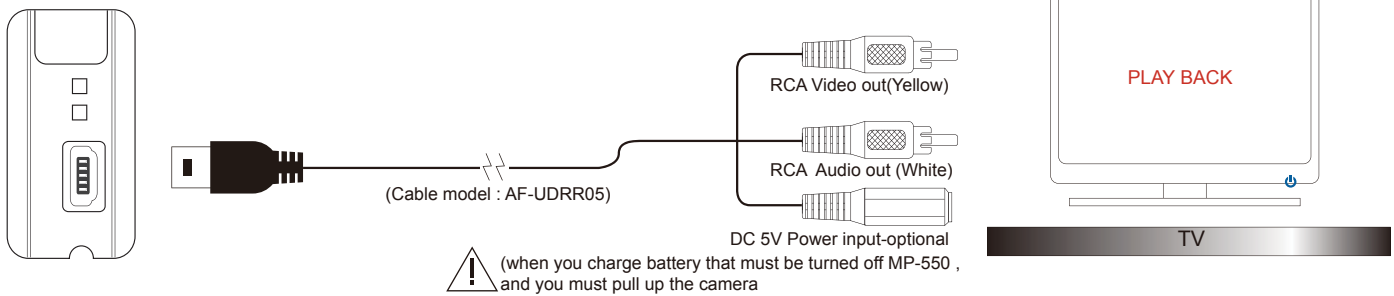
**2. Connect to PC**

a. After power on ,USB cable connected MP-550 ,that will into USB Mass Storage Device

3. Power charge

a. USB cable support PC transmission function and support power charge (when you charge battery that must be turned off MP-550 , and you must pull up the camera)

- Battery Charging ,the mp-550 red indicator light will lighten

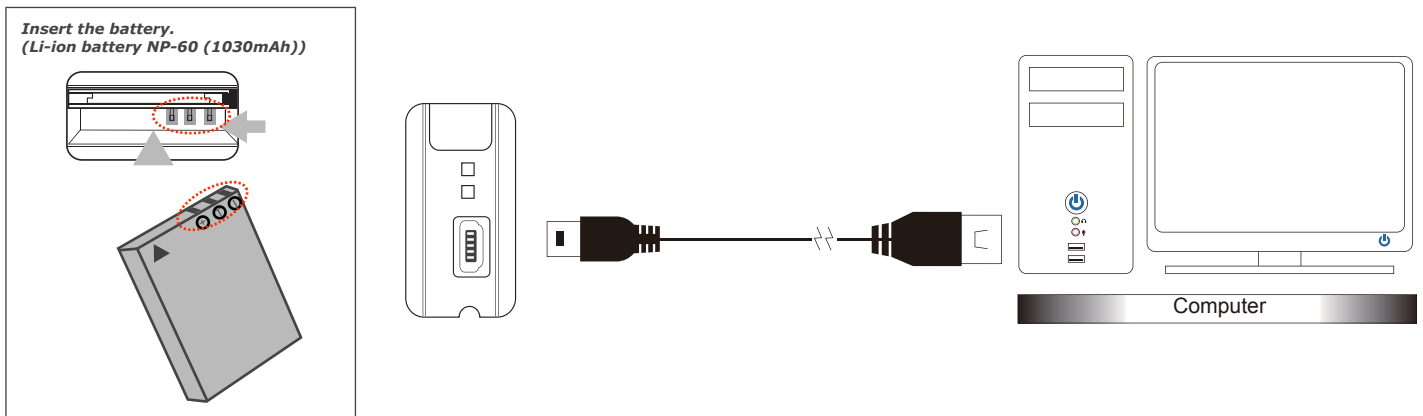
**Other information****CCIQ II Helmet Camera + Mini simple DVR**
ST-3501 + MP-550**ST-3501**

1/4" Color CCIQ II Helmet Camera
316K(NTSC & PAL)
400 TV Lines
3.9mm/F2.8

